

Permit No. _____

Fee: _____

SIDE SEWER PERMIT

City of Ketchikan Department of Public Works

2930 Tongass Avenue, Ketchikan, AK 99901

Phone 228-4726 Fax 225-8721

Site Location

Date:	Service Address		
US Survey No.	Block	Lot	Parcel No.

Applicant Information

Applicant Name:		Property Owner Name (if different):	
Mailing Address:		Mailing Address	
Phone Day:	Evening	Phone Day:	Evening
Fax No.	Email	Fax No.	Email:

Description of Work

Type of Work (check):	New Sewer Lateral	Repair to Existing Sewer:	Capping of Exist. Sewer (Abandon)
-----------------------	-------------------	---------------------------	-----------------------------------

For Construction in Right of Way	For Construction on Private Property
All pipe in R.O.W. must be C-900 PVC unless otherwise approved by City of Ketchikan.	All pipe on Private Property must be C-900 PVC unless otherwise approved by City of Ketchikan
Diameter of Pipe (min 6"):	Diameter of Pipe (min. 4"):
Depth at Edge of ROW (min. 4'):	Depth at Edge of Property Line (min. 3'):
Depth at Main: (min. 5')	Depth at Building (min 1.5'):
Type of Connection at Main:	Type of Connection at Service Stub:

Site Plan

Please submit two sets of Site plans detailing work to be done – one will be returned to applicant with corrections noted.

The plan shall show: lot lines; buildings; streets; location of bends, cleanouts, connections; pipe slope, size and type.

Upon completion of work, It is REQUIRED that the drawings be resubmitted showing any AS-BUILT revisions

Site Plan Submitted? (Y/N)	Date	Checked By:
As-built Plan submitted? (Y/N)	Date	Checked by:

Important Notice

This permit is required under Title 12 "SEWERS" of the City of Ketchikan Municipal Code.

- All work must be inspected before covering or backfilling of trench and inspector must be notified 24 hours in advance. Notice shall be given when work is ready for inspection. Connection to the main or side sewer shall be done in the presence of the inspector. Call 225-8750 to schedule inspection (Monday – Friday 8:00am to 4:30pm)
- All sewer line construction must conform to City of Ketchikan Standards. Private property work must also conform to State Plumbing Codes.
- A minimum sewer line slope of 2% (1/4 inch per-1foot) is required.
- Traffic area backfill must use competent material and be compacted in 6" lifts to a minimum 95% of maximum density.
- Cleanouts are required at a minimum: (1) at property line, (1) within 5' of building, and (1) at each bend over 45 degrees.
- Open lines to the sewer main must be capped if abandoned or until final tie-in is completed. At no time can storm water, dirt, and/or debris be allowed to enter the city system.
- Gutter drains, downspouts, or storm water collection systems are prohibited from being connected to the sewer system. They must be routed to a storm drainage system.
- If work requires working in the Public Right of Way, or around other utilities, you need a Permit to Excavate in Right of Way
- Sewer lines subjected to Tide water face more stringent standards for material type, joints, and hangars.

Keep this permit on site and ready for review/inspection at all times:

Pipe, compaction and backfill inspected by:	Date
Work completed on:	Date

I certify that the information submitted is true and accurate and meets applicable City Codes: _____

Applicant Signature and Date



2930 Tongass Avenue
Ketchikan, Alaska 99901
Phone: 907-228-4727
Fax: 907-225-8721

City of Ketchikan Municipal Code: Sewers 12.08.042 Permit fees.

Prior to issuance of any permit, all fees shall be paid to the city in accordance with the following schedule:

(a) Side Sewers Permit Cost	
(1) Single-family residence	\$20.00
(2) Multiple-family residence for first dwelling unit	20.00
For each additional dwelling unit	10.00
(3) Commercial building for first 1000 square feet	20.00
For each additional 1000 square feet	10.00
(4) Repairs to existing side sewers	20.00
(5) Capping off	15.00
(6) Renewal of existing permit before expiration	15.00
(7) For each trip by survey crew	75.00
(8) Inspection of the installation of sewer stub in unpaved right-of-way	60.00
(9) Inspection of the installation of sewer stub and street restoration in right-of-way when streets are paved with asphalt or concrete	110.00
(10) For each inspection trip required in unusual situations not covered above:	25.00



Project:

EXAMPLE SEWER
SITE PLAN

NEW SEWER SERVICE
USMS 0000, BLOCK 001, LOT 00
100 ANYSTREET, KETCHIKAN AK

Date: JAN. 1, 2006

Scale: 1:40

Drawn By: S. Brakke

Approved By:

Drawing No.

Sheet No. 2 OF 3

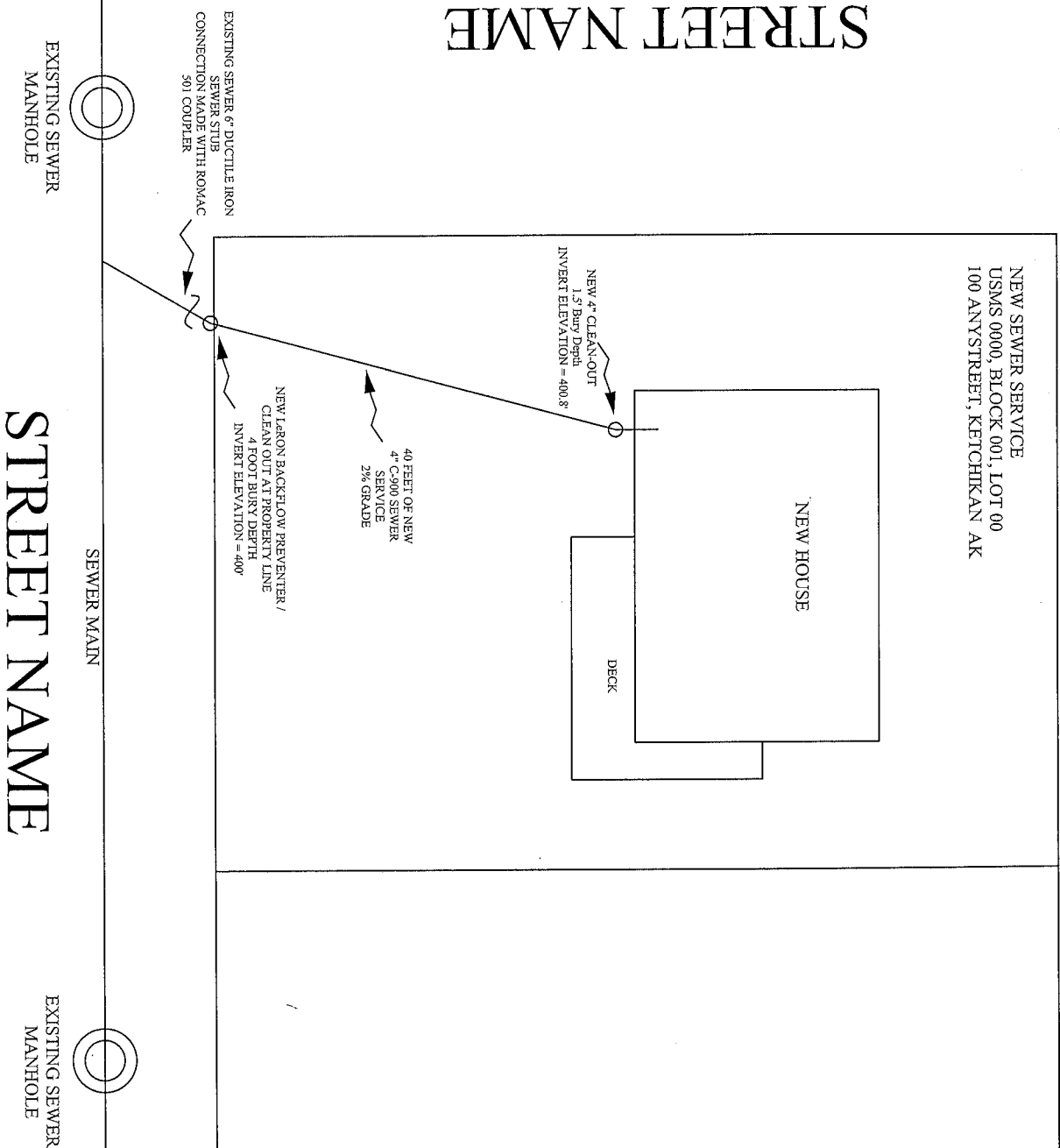

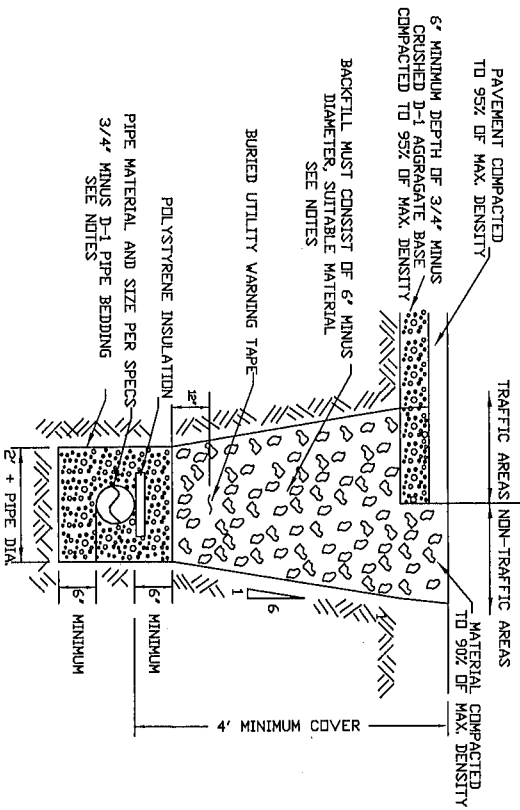

TYPICAL SEWER TRENCH

N.T.S.

NOTES

1. BACKFILL MATERIAL MUST BE COMPACTED TO 95% OF MAX. DENSITY WITHIN TRAFFIC AREAS AND TO 90% MAX DENSITY OUTSIDE OF TRAFFIC AREAS
2. BACKFILL MATERIAL MUST BE FREE OF ORGANIC MATTER AND NON-FROST SUSCEPTIBLE
3. TRENCH BACKFILL MUST BE PLACED IN 12" MAX. LIFTS BETWEEN COMPACTION
4. IF UNSUITABLE PIPE FOUNDATION MATERIAL IS ENCOUNTERED DURING EXCAVATION, ENGINEER MAY REQUIRE THE CONTRACTOR TO OVER-EXCAVATE AND BACKFILL WITH SUITABLE MATERIAL
5. PIPE BEDDING MATERIAL MUST BE PLACED IN 6" MAX LIFTS AND COMPACTED TO 95% OF MAXIMUM DENSITY
6. NEED FOR SEWER LINE INSULATION TO BE DETERMINED BY DEPTH OF COVER

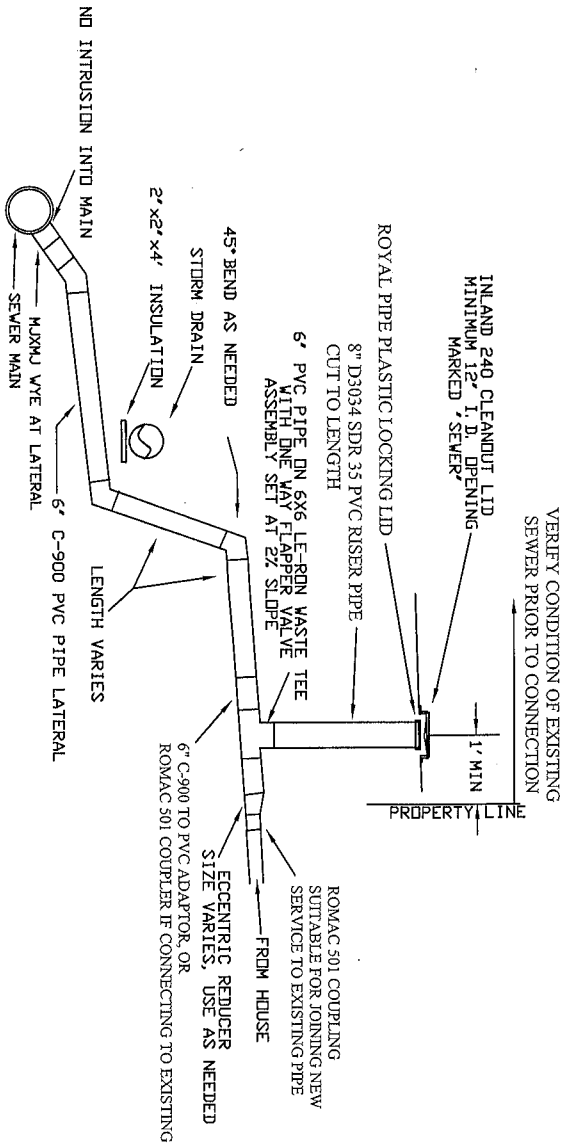

TYPICAL SEWER LATERAL PROFILE

N.T.S.

NOTES:

1. MINIMUM SLOPE OF .02 FT/FT
2. CONNECTIONS FROM ROOF DOWNSPOUTS, AREA DRAINS, ETC. ARE PROHIBITED
3. TRENCH MUST BE DE-WATERED
4. PIPE MUST BE LAID ON AND BEDDED WITH COMPACTED AND COMPETENT MATERIAL



City of
Ketchikan

Project:

STANDARD SEWER DETAILS

Date: Jan. 1, 2007

Scale: NTS

Drawn By: S. Brakke

Approved By:

Drawing No.

Sheet No. 3 OF 3